

Features

5.6mm package and 650nm 4mW 50°C operation

Low operation current

Saving space and cost of laser module

Voltage driven LD, easy to use

Absolute maximum ratings



Parameter	Symbol	Rating	Unit
Power supply voltage	V _{cc}	3.3	V
Laser optical output power	P _o	7	mW
Operation temperature	T _{opr}	-10~+50	°C
Storage temperature	T _{stg}	-40~+85	°C

Electrical and optical characteristics (T_c=25 °C)

Parameter	Symbol	Min.	Typ.	Max.	Unit	Conditions
Wavelength	λ	645	655	660	nm	P _o = 3mW
Optical output power	P _{out}	2	-	3	mW	V _{cc} =3V
Operation current	I _{op}	-	25	30	mA	P _o =3mW
Operation voltage	V _{op}	2.7	3	3.3	V	P _o =3mW
Parallel divergence angle	θ	6	8	12	Deg	P _o =3mW
Perpendicular divergence angle	$\theta -$	24	27	32	Deg	P _o =3mW
Parallel FFP deviation angle	$\Delta \theta$	-3.0	0	+3.0	Deg	P _o =3mW
Perpendicular FFP deviation angle	$\Delta \theta$	-3.0	0	+3.0	Deg	P _o =3mW
Emission point accuracy	$\Delta x\Delta y\Delta z$	-80	0	+80	um	P _o =3mW

Outline Dimension & Pin Assignment:

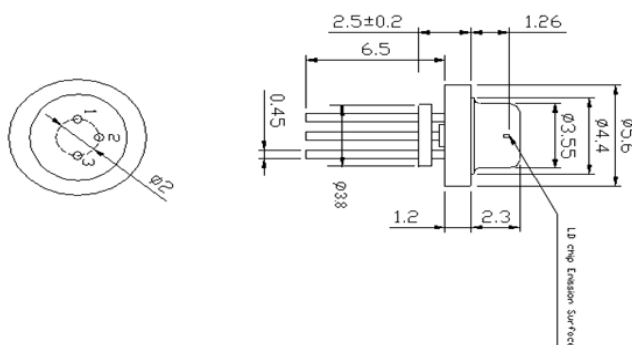

UNIT : mm

Pin 1 : V_{cc}

Pin 2 : GND

Pin3 : NC (no external connection)

● Precautions

- * Do not operate the device above maximum ratings. Doing so may cause unexpected and permanent damage to the device.
- * Take precautions to avoid electrostatic discharge and/or momentary power spikes. A change in the characteristics of the laser or premature failure may result.
- * Proper heat sinking of the device assures stability and lifetime. Always ensure that maximum operating temperatures are not exceeded.
- * Observing visible or invisible laser beams with the human eye directly, or indirectly, can cause permanent damage. Use a camera to observe the laser.
- * No laser device should be used in any application or situation where life or property is at risk in event of device failure.
- * Specifications are subject to change without notice. Ensure that you have the latest specification by contacting us prior to purchase or use of the product.

ARIMA LASERS CORP.

PHONE: 886-3-4699800 | FAX: 886-3-4699600

E-MAIL: Ldsales@arimalasers.com | www.arimalasers.com

For reference only. Contents above are subject to change without notice.