

# Blue Laser Diode Module **AML-D200-450050-01**

## 50mW Blue Laser Module

### Features

1. APC (auto power control) driver circuit
2. Wide input voltage range (3~ 6VDC)
3. Stable Output power of <50mW
4. High quality glass lens for output beam

### Applications

1. General purpose blue laser light source
2. Industrial laser marker

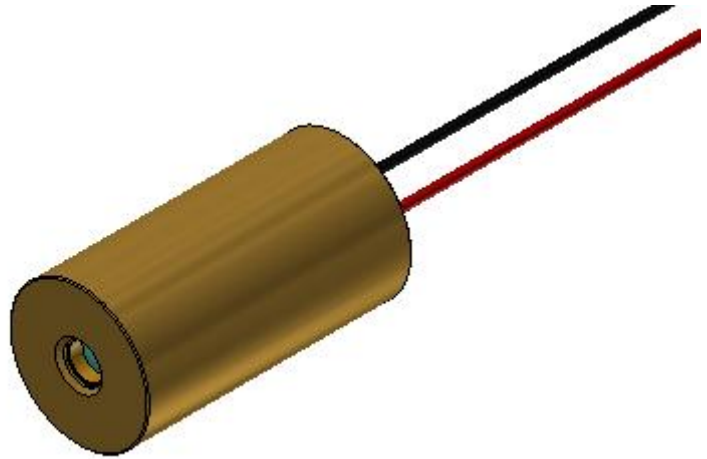

### Part No. Indications:

AML- D 200 - 450 050 - 01

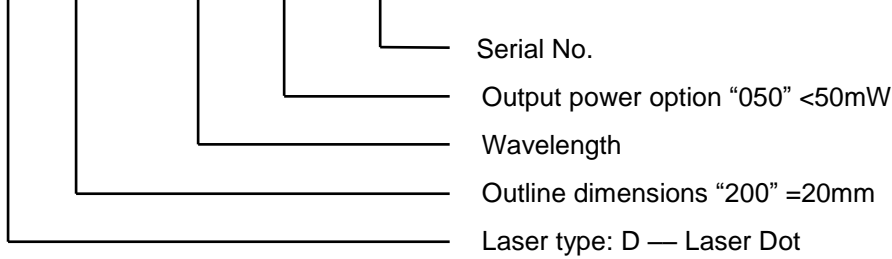

### Absolute maximum ratings ( $T_c=25^\circ\text{C}$ )

Item	Symbol	Rating	Unit
Power supply voltage	$V_{cc}$	6	V
Laser Module optical output power	$P_o$	55	mW
Operation Case Temperature	$T_c$	0~60	$^\circ\text{C}$
Storage Temperature	$T_{stg}$	-40~80	$^\circ\text{C}$

### Electrical and optical characteristics ( $T_c=25^\circ\text{C}$ )

Item	Symbol	Min.	Typ.	Max	Unit	Condition
Wavelength	$\lambda$	440	450	460	nm	$P_o=50\text{mW}$
Output power	$P_{out}$		<50		mW	$V_{cc}=3\text{V}$
Operation current	$I_{op}$	-	180	250	mA	$P_o=50\text{mW}$ $V_{cc}=3\text{V}$
Operation voltage	$V_{op}$	3		6	Volt	
Laser Beam spot size at 10m				<15mm		
Divergence angle				1.5 mrad		

# Blue Laser Diode Module **AML-D200-450050-01**

**Outline dimensions (Units: mm)**

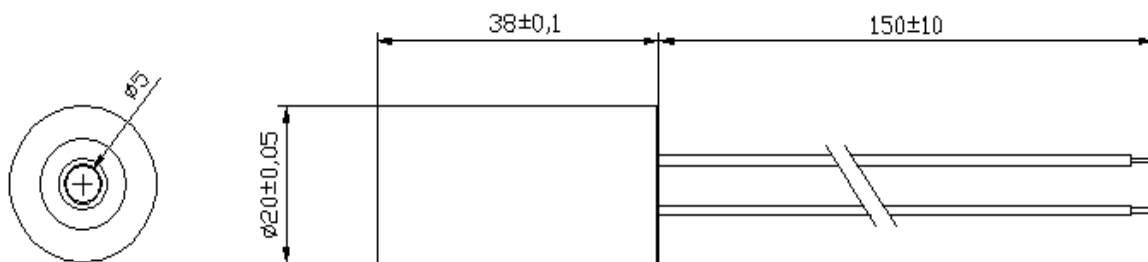

**Red wire : Vcc**

**Black wire : GND**

## **Laser Safety Precautions**

1. Do not look into the laser beam directly by eyes. The laser beam may cause severe damage to human eyes.
2. Optical Lens is made of glass . Do not contaminate lens by soiling, oil or chemical.