

# Visible Cone Laser Module

APFD-635-02-C3-TA

6-2D-LM63-040\_Rev.00

## Φ10mm 635nm 360° Line Laser Module

### Features

- APC (auto power control) IC inside
- full 360 ° laser line
- High brightness
- better line quality

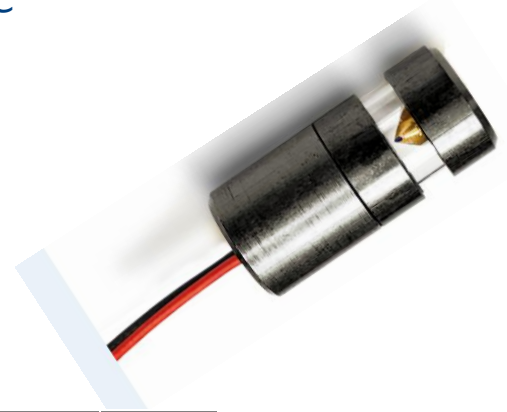

### Absolute maximum ratings

Parameter	Symbol	Rating	Unit
Power supply voltage	Vcc	5.5	V
Laser Module optical output power	Po	<3	mW
Operation temperature	Topr	-5~40	°C
Storage temperature	Tstg	-40~75	°C

### Electrical and optical characteristics (T<sub>c</sub>=25 °C)

Parameter	Symbol	Min.	Typ.	Max.	Unit	Conditions
Wavelength	λ	635	638	643	nm	Po= 3mW
Operation current	Iop	-	-	40	mA	Po= 3mW ; Vcc=3V
Optical output power (Dot)	Pout	2	-	3	mW	
Operation voltage	Vop		3	5	Volt	
Line thickness at 3M				<4mm		
Emitting angle				360°		

\* Sufficient heat dissipation is required for CW operation.

ARIMA LASERS CORP.

PHONE: 886-3-4699800 | FAX: 886-3-4699600

E-MAIL: Ldsales@arimalasers.com | www.arimalasers.com

For reference only. Contents above are subject to change without notice.

**Arima**  
LASERS

## Φ10mm 635nm 360° Line Laser Module

Outline dimensions (Units: mm)

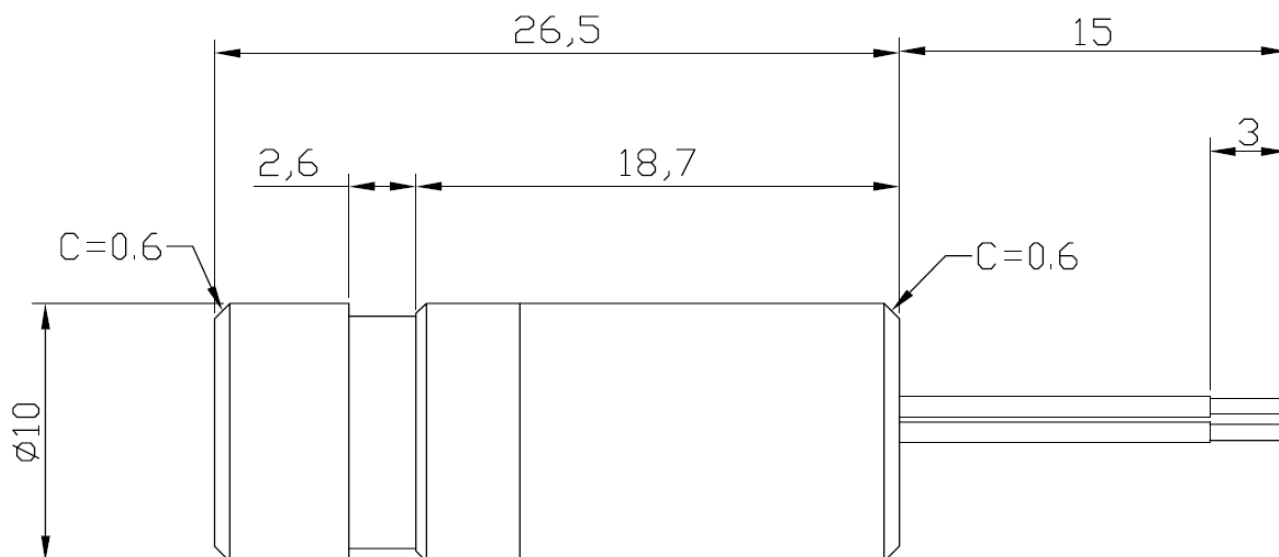

**Red wire : Vcc**

**Black wire : GND**

### • Precautions

- \* Do not operate the device above maximum ratings. Doing so may cause unexpected and permanent damage to the device.
- \* Take precautions to avoid electrostatic discharge and/or momentary power spikes. A change in the characteristics of the laser or premature failure may result.
- \* Proper heat sinking of the device assures stability and lifetime. Always ensure that maximum operating temperatures are not exceeded.
- \* Observing visible or invisible laser beams with the human eye directly, or indirectly, can cause permanent damage. Use a camera to observe the laser.
- \* No laser device should be used in any application or situation where life or property is at risk in event of device failure.
- \* Specifications are subject to change without notice. Ensure that you have the latest specification by contacting us prior to purchase or use of the product.

**ARIMA LASERS CORP.**

PHONE: 886-3-4699800 | FAX: 886-3-4699600

E-MAIL: [Ldsales@arimalasers.com](mailto:Ldsales@arimalasers.com) | [www.arimalasers.com](http://www.arimalasers.com)

*For reference only. Contents above are subject to change without notice.*

**Arima**  
LASERS